



Existing 01:00pm

March 21st (GMT)



Proposed 01:00pm



Existing 02:00pm

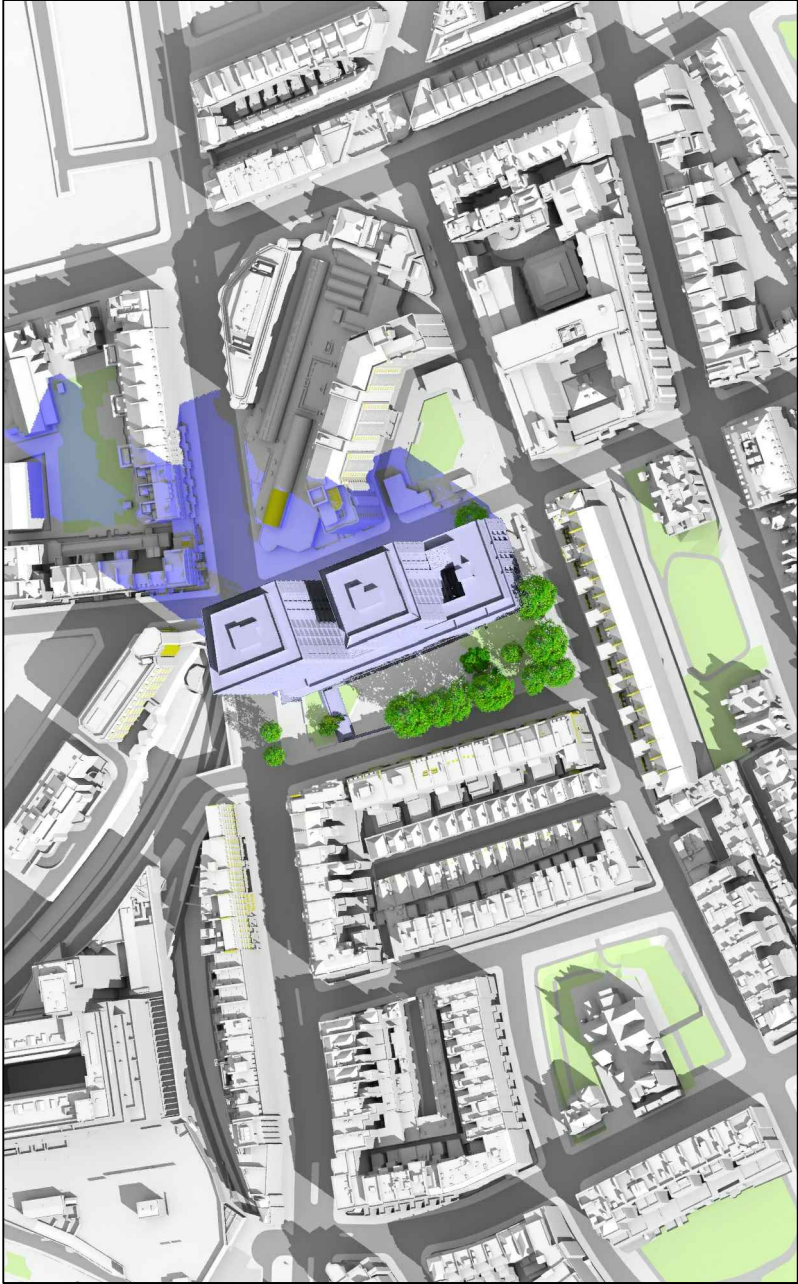

Proposed 02:00pm

Sources: Point2 Surveys:
Site Photos
Point Cloud Data

Ordnance Survey:
OS Map
Zmap

SimpsonHaugh and Partners:
Received 03/12/18
10061-Z0-G200-3-AL-Detailed Model.dwg
10106-A-DRG-Z0-G100-4000(0-3).dwg's Elevations
10106-A-DRG-Z0-G200-2000(00-31).dwg's Plans

Key:

- Grey shadows are those caused by buildings which are not on the site under development.
- Green shadows are those caused specifically by the existing buildings on the site.
- Blue shadows are those caused specifically by the proposed development.

Project: Kensington Forum Hotel

Title: Transient Overshadowing
Tree Assessment

Drawn By: SA/CJ

Scale: NTS

Date: DEC 2018

Dwg No: **P813/ MAR1/04**

Point 2 Surveyors Ltd,
3rd Floor
17 Slingby Place,
London WC2E 9AB,
0207 836 5828
www.point2surveyors.com





Existing 03:00pm

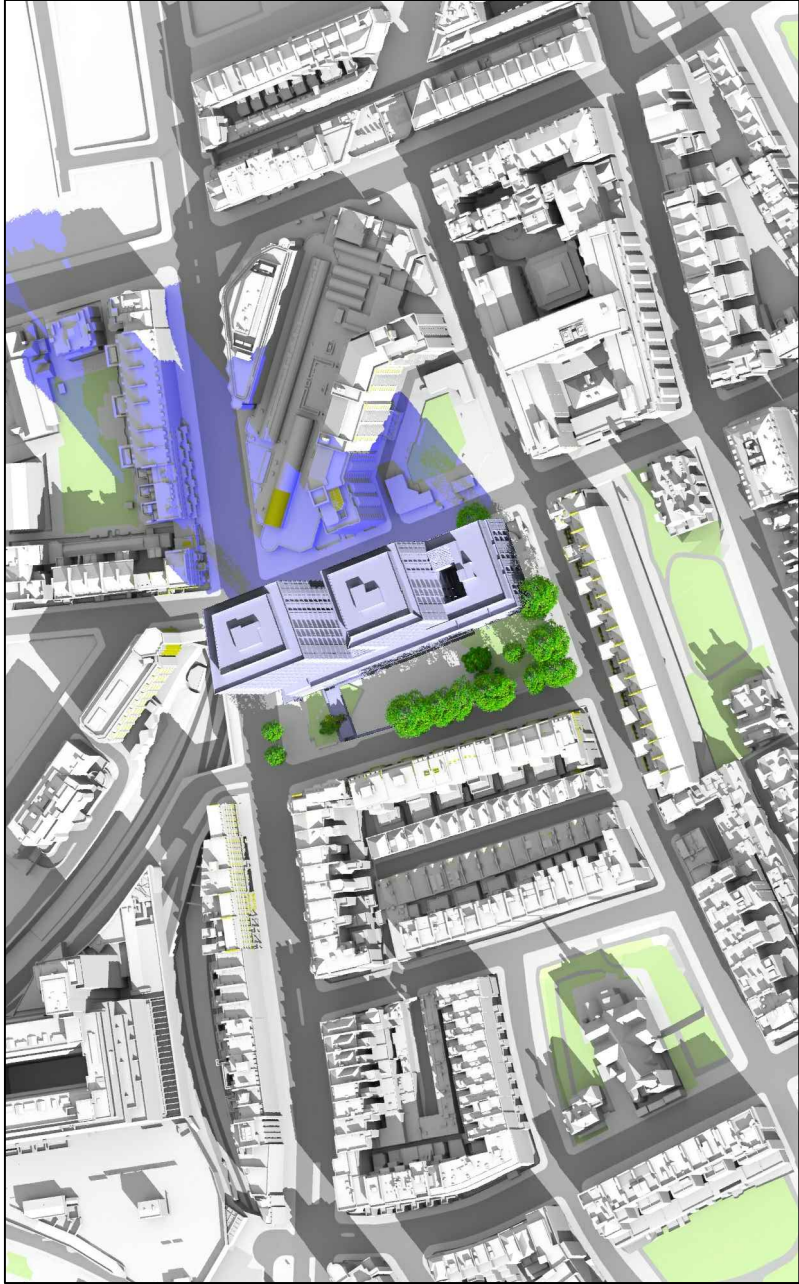

Proposed 03:00pm

March 21st (GMT)

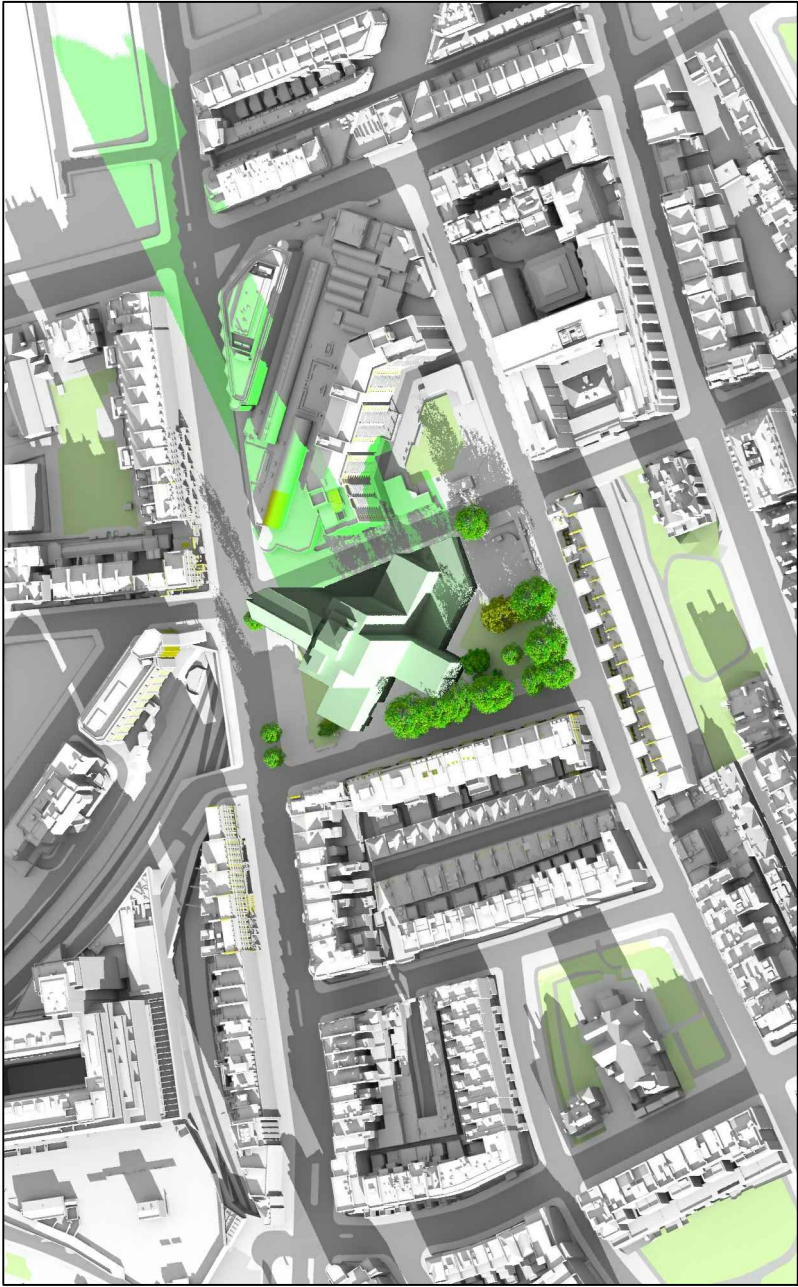

Existing 04:00pm

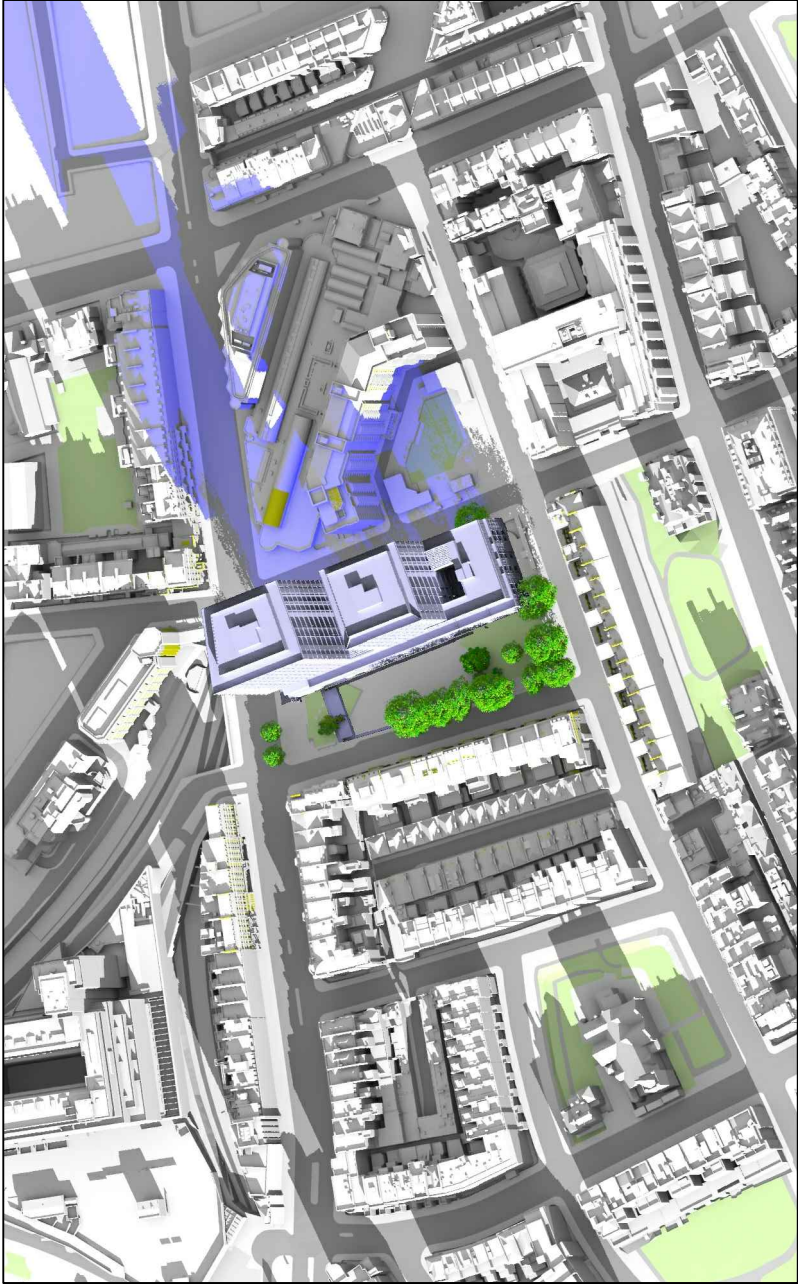

Proposed 04:00pm

Sources: Point2 Surveyors:
Site Photos
Point Cloud Data

Ordnance Survey:
OS Map
Zmap

SimpsonHaugh and Partners:
Received 03/12/18
10061-Z0-G200-3-AL-Detailed Model.dwg
10106-A-DRG-Z0-G100-4000(0-3).dwg's Elevations
10106-A-DRG-Z0-G200-2000(00-31).dwg's Plans

Key:

- Grey shadows are those caused by buildings which are not on the site under development.
- Green shadows are those caused specifically by the existing buildings on the site.
- Blue shadows are those caused specifically by the proposed development.

Project: Kensington Forum Hotel

Title: Transient Overshadowing
Tree Assessment

Drawn By: SA/CJ

Scale: NTS

Date: DEC 2018

Dwg No: **P813/ MAR1/05**

Point 2 Surveyors Ltd,
3rd Floor
17 Slingby Place,
London WC2E 9AB,
0207 836 5828
www.point2surveyors.com





Existing 05:00pm

March 21st (GMT)

Proposed 05:00pm

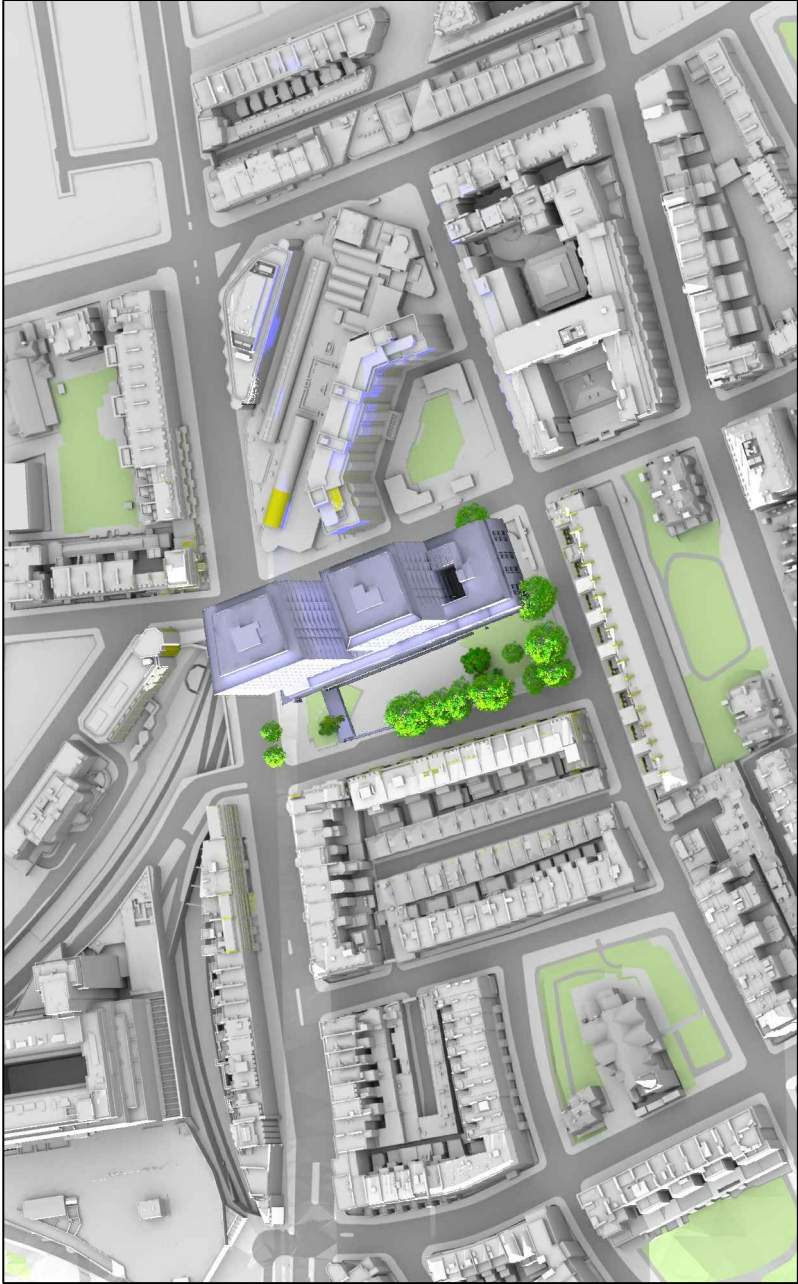
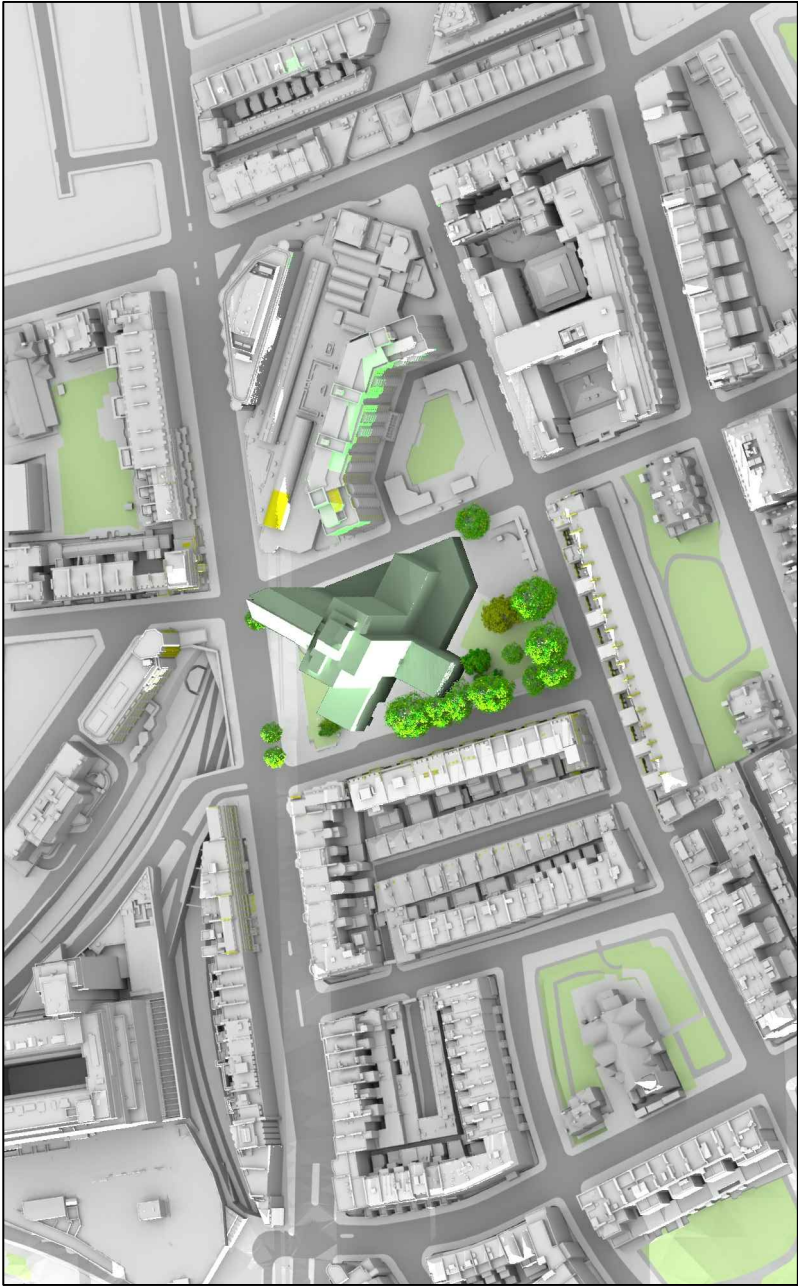

Existing 06:00pm

Proposed 06:00pm

Sources: Point2 Surveyors:
Site Photos
Point Cloud Data

Ordnance Survey:
OS Map
Zmap

SimpsonHaugh and Partners:
Received 03/12/18
10061-Z0-G200-3-AL-Detailed Model.dwg
10106-A-DRG-Z0-G100-4000(0-3).dwg's Elevations
10106-A-DRG-Z0-G200-2000(00-31).dwg's Plans

Key:

- Grey shadows are those caused by buildings which are not on the site under development.
- Green shadows are those caused specifically by the existing buildings on the site.
- Blue shadows are those caused specifically by the proposed development.

Project: Kensington Forum Hotel

Title: Transient Overshadowing
Tree Assessment

Drawn By: SA/CJ

Scale: NTS

Date: DEC 2018

Dwg No: **P813/ MAR1/06**

Point 2 Surveyors Ltd,
3rd Floor
17 Slingsby Place,
London WC2E 9AB,
0207 836 5828
www.point2surveyors.com





Existing 06:00am



June 21st (BST)

Proposed 06:00am



Existing 07:00am

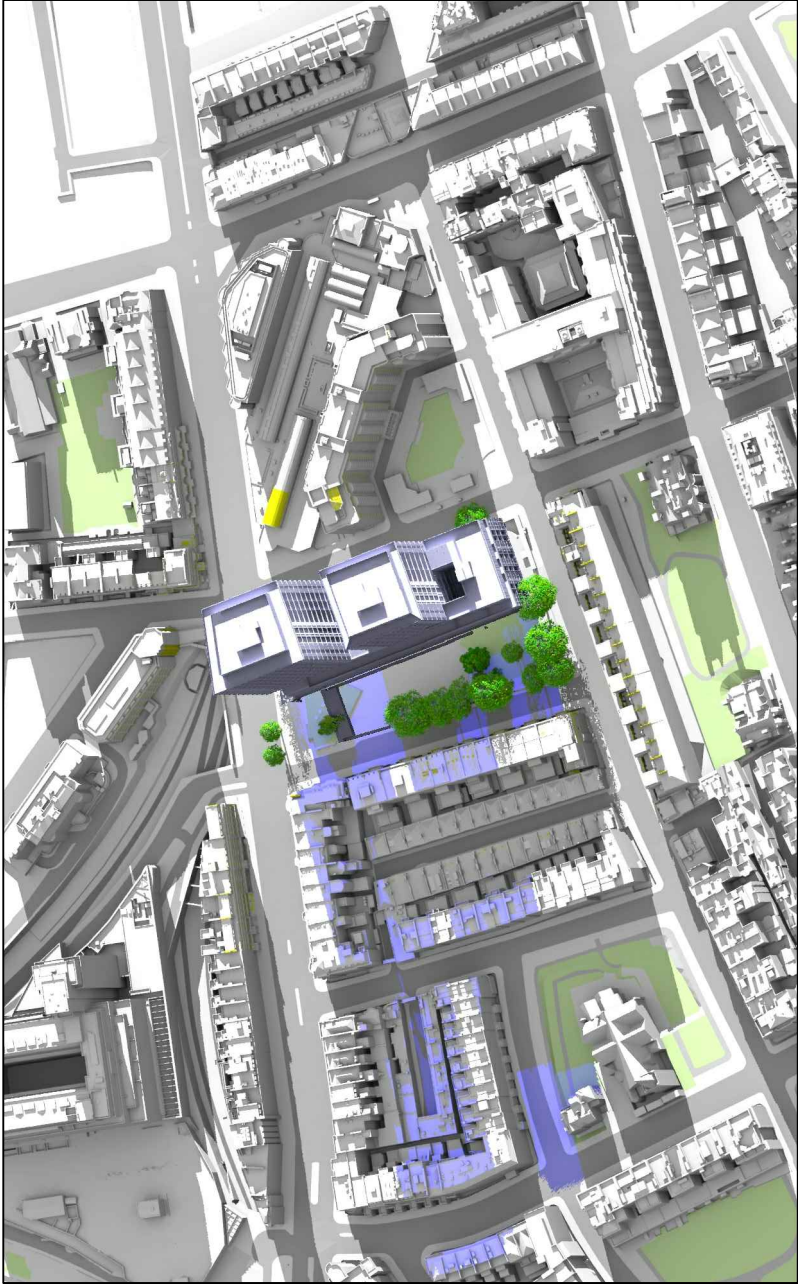

Proposed 07:00am

Sources: Point2 Surveyors:
Site Photos
Point Cloud Data

Ordnance Survey:
OS Map
Zmap

SimpsonHaugh and Partners:
Received 03/12/18
10061-Z0-G200-3-AL-Detailed Model.dwg
10106-A-DRG-Z0-G100-4000(0-3).dwg's Elevations
10106-A-DRG-Z0-G200-2000(00-31).dwg's Plans

Key:

Grey shadows are those caused by buildings which are not on the site under development.

Green shadows are those caused specifically by the existing buildings on the site.

Blue shadows are those caused specifically by the proposed development.

Project: Kensington Forum Hotel

Title: Transient Overshadowing
Tree Assessment

Drawn By: SA/CJ

Scale: NTS

Date: DEC 2018

Dwg No: **P813/ JUN1/01**

Point 2 Surveyors Ltd,
3rd Floor
17 Slingby Place,
London WC2E 9AB,
0207 836 5828
www.point2surveyors.com





Existing 08:00am



Proposed 08:00am

June 21st (BST)



Existing 09:00am



Proposed 09:00am

Sources: Point2 Surveyors:
Site Photos
Point Cloud Data

Ordnance Survey:
OS Map
Zmap

SimpsonHaugh and Partners:
Received 03/12/18
10061-Z0-G200-3-AL-Detailed Model.dwg
10106-A-DRG-Z0-G100-4000(0-3).dwg's Elevations
10106-A-DRG-Z0-G200-2000(00-31).dwg's Plans

Key:

- Grey shadows are those caused by buildings which are not on the site under development.
- Green shadows are those caused specifically by the existing buildings on the site.
- Blue shadows are those caused specifically by the proposed development.

Project: Kensington Forum Hotel

Title: Transient Overshadowing
Tree Assessment

Drawn By: SA/CJ

Scale: NTS

Date: DEC 2018

Dwg No: **P813/ JUN1/02**

Point 2 Surveyors Ltd,
3rd Floor
17 Slingby Place,
London WC2E 9AB,
0207 836 5828
www.point2surveyors.com





Existing 10:00am

June 21st (BST)



Proposed 10:00am



Existing 11:00am

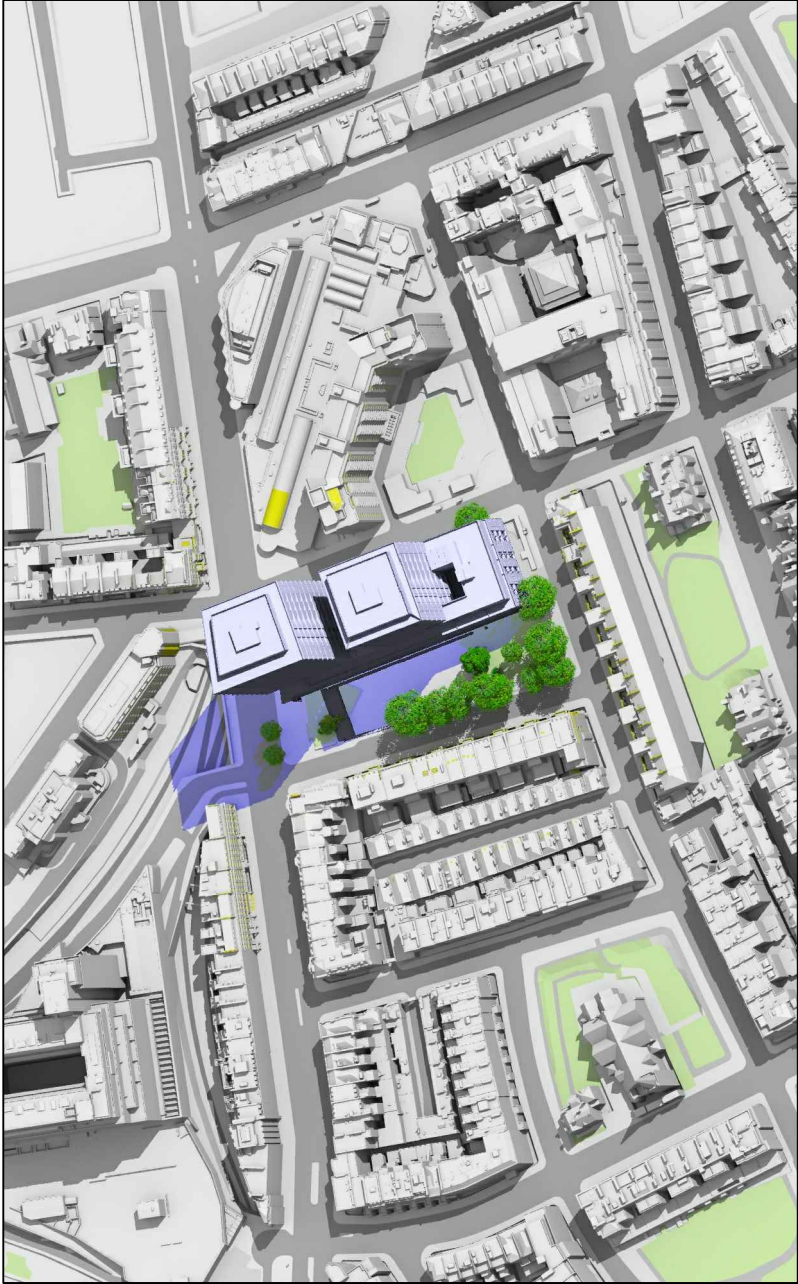

Proposed 11:00am

Sources:
Point2 Surveyors:
Site Photos
Point Cloud Data

Ordnance Survey:
OS Map
Zmap

SimpsonHaugh and Partners:
Received 03/12/18
10061-Z0-G200-3-AL-Detailed Model.dwg
10106-A-DRG-Z0-G100-4000(0-3).dwg's Elevations
10106-A-DRG-Z0-G200-2000(00-31).dwg's Plans

Key:

- Grey shadows are those caused by buildings which are not on the site under development.
- Green shadows are those caused specifically by the existing buildings on the site.
- Blue shadows are those caused specifically by the proposed development.

Project: Kensington Forum Hotel

Title: Transient Overshadowing
Tree Assessment

Drawn By: SA/CJ

Scale: NTS

Date: DEC 2018

Dwg No: **P813/ JUN1/03**

Point 2 Surveyors Ltd,
3rd Floor
17 Slingby Place,
London WC2E 9AB,
0207 836 5828
www.point2surveyors.com

